

SENSORY ACTIVITY

Sensory Colour Bag

❑ What you need:

- Shaving cream
- Ziploc Bags
- Tempera paints
- Duct Tape

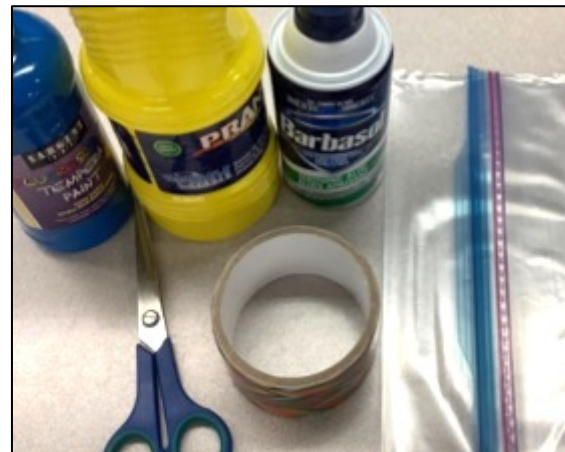

❑ Steps:

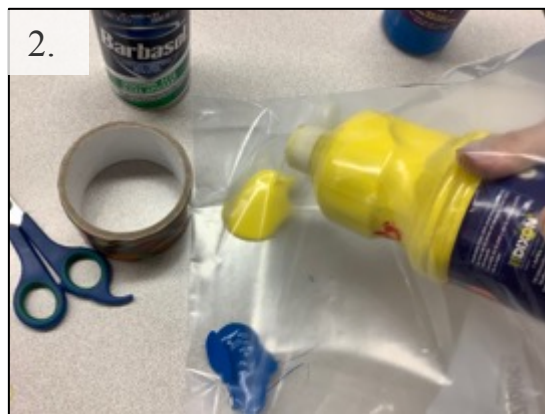
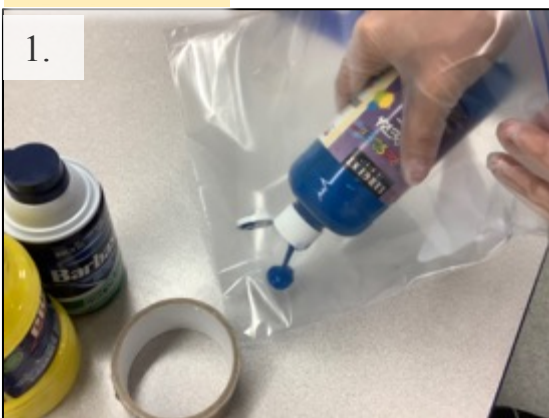

1 and 2. Take a Ziploc bag. Pour yellow paint into one corner of the bag, and blue paint into the other corner.

3. Spray in shaving cream, and push it down to the bottom of the bag.



4. Close the Ziploc bag, and use duct tape to keep it from opening.

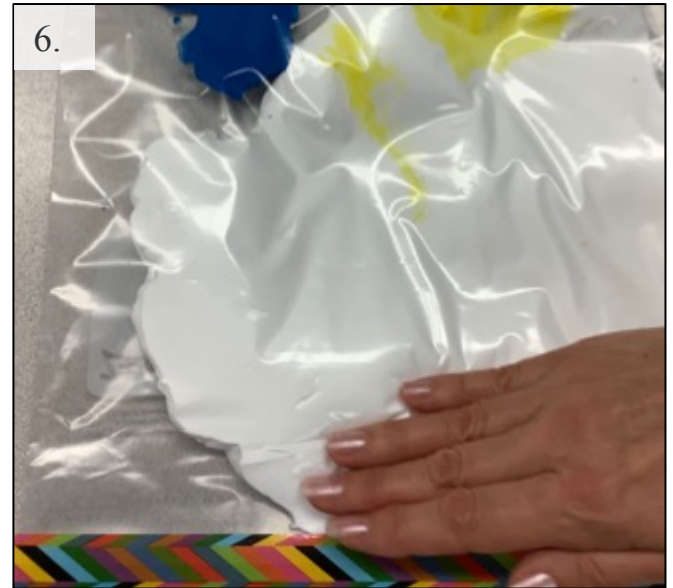

5 and 6. Children can explore the bag and mix the colours together. Try squishing, squashing and flattening the bag.



Try with your child:

Talk about how colours can be mixed to form different colours. For example, blue and yellow can form green. Try using other colour mixtures to see what new colours can be made.