

FINE MOTOR ACTIVITY

Cutting Snowflakes

☐ What you need:

- Coffee Filter
- Markers
- Scissor
- Water



Photos from <https://onelittleproject.com>

☐ Steps:



1. Spread out a coffee filter and decorate it with the markers.



2. Decorate many of these filters.



3. Soak the coffee filter with drops of water.

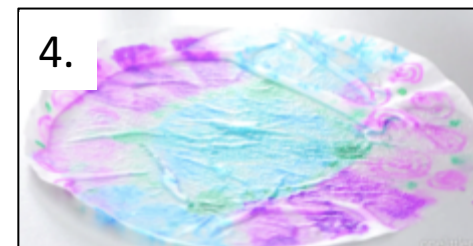

4. Let the wet coffee filters dry on a hard, flat surface.

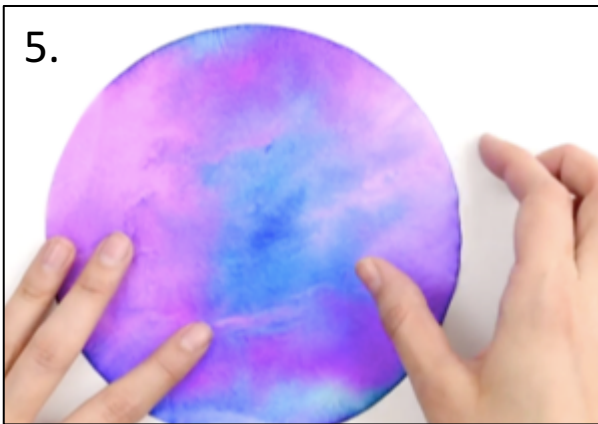

5. As the coffee filter dries out, the ink from the markers will spread out and mix together.

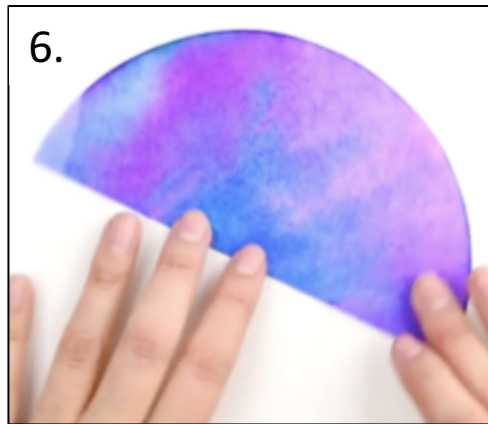

6. Once the coffee filter is dry, fold it in half.

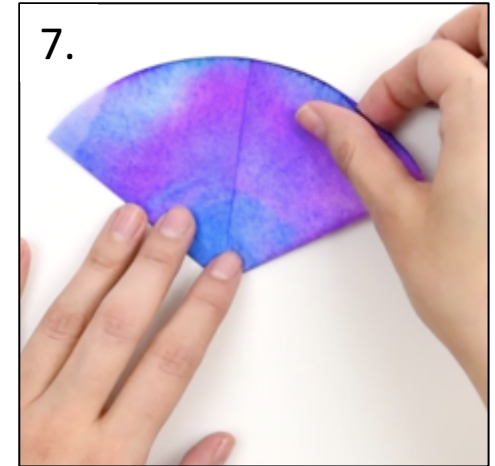

7. Fold the coffee filter again in thirds.

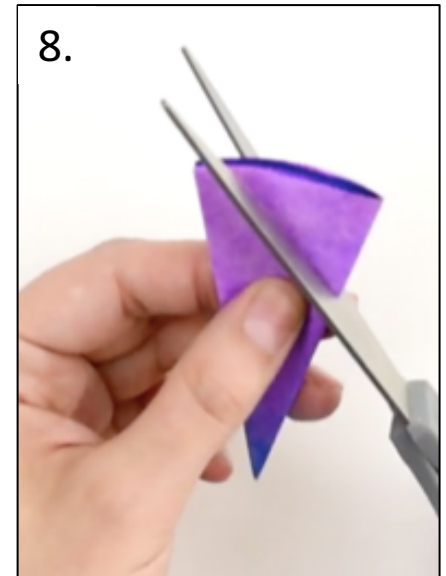

8. Cut out the folded corner on the wide side of the coffee filter.

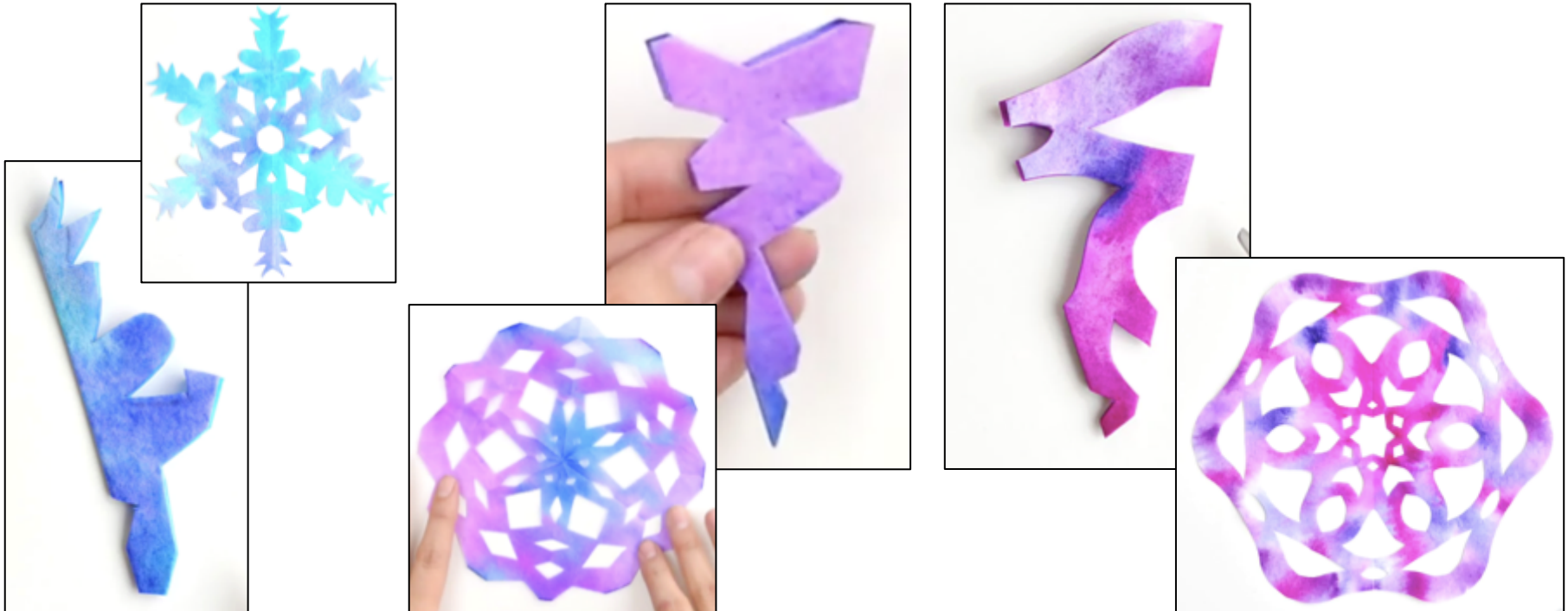

9. Cut horizontally into the sides of the folded filters to create these snowflake designs. The cuts can be curved or pointed, small or large! Use a variety of markers to create different color blends in your snowflakes as well.