

Coffee Filter Butterflies

What you need :

- Coffee filter
- Watercolor Paints
- Pipe cleaners
- Dropper or spoon
- Water
- Palette
- Large Tray



Step 1

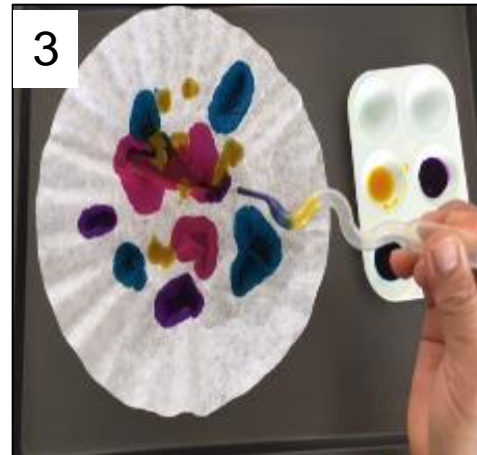

1, 2. Transfer water into each section of the palette using a dropper. Add few drops of watercolor paint to each section.

3, 4. Place a coffee filter on a tray and drip the color on it using a dropper or spoon. Leave the coffee filter on the tray until it dries.

5, 6. Use your fingers to pinch the filter in the middle, then place the pipe cleaner in the middle and twist it to secure in place.

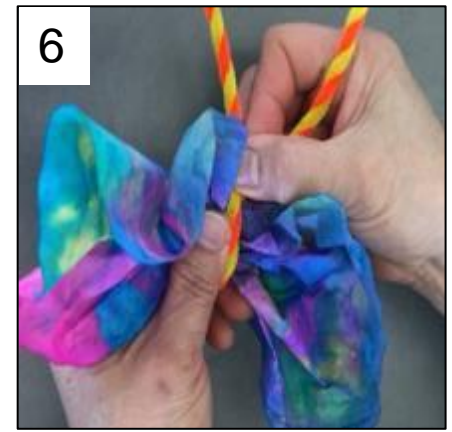

7. Bend the end of the pipe cleaner to create antennae for the butterfly.



8, 9. Gently spread out the coffee filter to create butterfly wings.

